



Spectrum Group Architects, P.C.

Roundup Memorial Hospital and Nursing Home Addition

Total Cost
\$125,000
X-Ray/Emergency
\$1,329,000
Nursing Home

Client:
Musselshell County
Board of Commissioners

Location:
Roundup, MT



Entrance

The first phase of work included an addition to the hospital creating a new emergency room entrance and radiology suite. Interior spaces were remodeled enlarging the emergency room and facilities.

The second phase of construction provided an addition of 21 long-term care beds, expanded kitchen facilities, dining and administrative spaces. The scope of the project also required a new coal fired boiler system and electrical service to the building.

*Architecture
Matters*

New Floor Plan

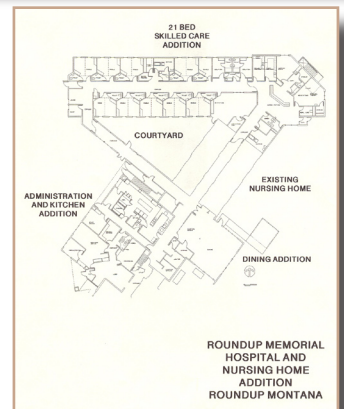

Nursing Home
Entrance