



Freight Agency - Warehouse, Offices, Truck Maintenance, Storage

Total Cost
\$1,230,000

Area:
28,836s.f.

Client:
Freight Agency/Diversified
Transfer and Storage

Location:
Billings, MT



This dynamic and growing business required a durable facility that could stand up to the riggers of a warehouse distribution center while still presenting an attractive image. The program called for the warehouse to be expandable to accommodate the growing business.

This facility has its own tractor maintenance facility and wash bay with a water recycler.

This facility was designed with the office space up front and the warehouse and truck maintenance facility in the rear.

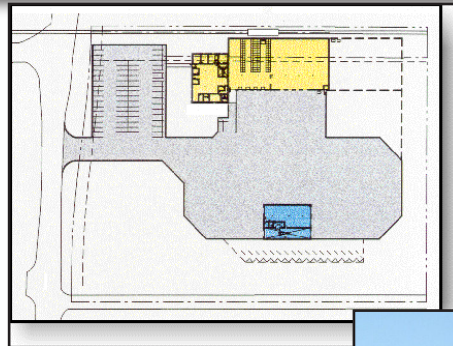

*Architecture
matters*